

Glass Door Merchandiser Refrigerators

SLIDING DOORS EM SERIES



EMGR33



EMGR33B



EMGR48



EMGR48B



EMGR69



EMGR69B

Cabinet Construction

- Heavy duty white coated steel interior/exterior. Black exterior standard for models EMGR33B, EMGR48B and EMGR69B.
- Open spaced interior with no walls between compartments.
- Stainless steel floor interior has rounded corners and detachable drain plug for ease of cleaning.
- 2.5" thick high density polyurethane insulation.
- Four height adjustable screw legs (six legs for models EMGR69 and EMGR69B).

Refrigeration System

- Bottom mounted, self-contained and fully detachable Blizzard R290 condensing unit uses environmentally friendly, EPA-compliant R290 refrigerant with zero (0) Ozone Depletion Potential (ODP) and three (3) Global Warming Potential (GWP). Blizzard R290 is easily replaceable and requires no on-site brazing.
- Electronically commutated (ECM) fan motors achieve rapid cooling with less energy consumption.
- Full-length air duct ensures optimal cold air distribution.
- Air circulation guard keeps floor vents from obstruction.
- Time-initiated and temperature-terminated auto defrost cycle for seamless operation.
- Large capacity, corrosion-resistant condenser and evaporator coils.
- Self-maintaining, energy-efficient condensate drain pan requires no external drains or electric heaters.
- High performance, auto-reverse condenser fan motor supports compressor ventilation and condenser coil cleaning.
- Pre-wired and ready to plug, 115V/60Hz/1Ph, NEMA 5-15P.

Lighting

- Shielded LED bar lighting with on/off switch provides bright, high color illumination at lower heat output.

Doors

- Low emissivity double glass panes reflect UV rays for efficient cooling.
- Black PVC frames.
- Self-closing with heavy duty door bumpers for impact absorption.
- Removable doors and door tracks for ease of cleaning.
- Pre-installed locks keep your items safe from theft.

Shelving

- Four epoxy coated, steel wire shelves with airflow guard per section.
- Height adjustable stainless steel clips.

Temperature Control

- Multi-function digital controller with easy to read LED display.
- Factory preset temperature, 35°F. Temp-set range from 33°F to 54°F.
- Audible overheat protection alarm for compressor and condenser coil.

Options

- Additional shelving.
- 5" or 3" swivel casters with locks on front set.
- 3.5"-6" height-adjustable and interchangeable legs.

↔ = Interior Dimensions ↔ = Exterior Dimensions

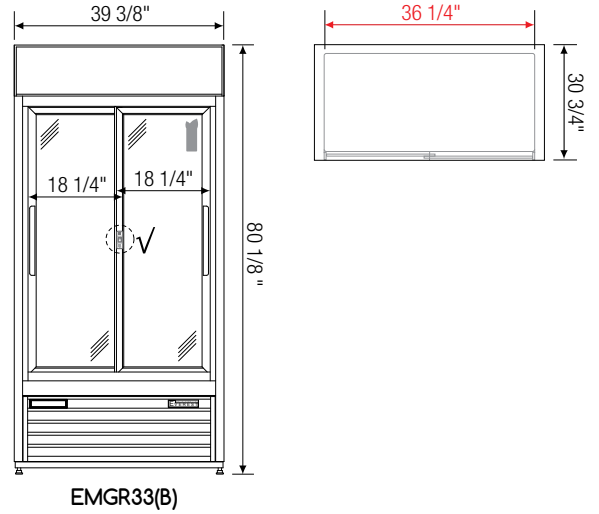
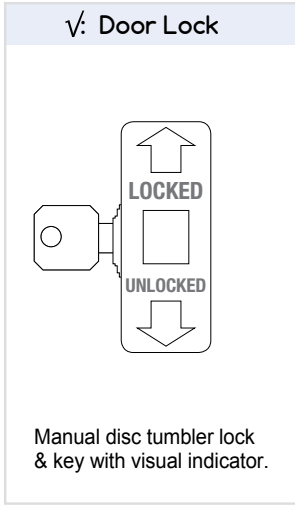
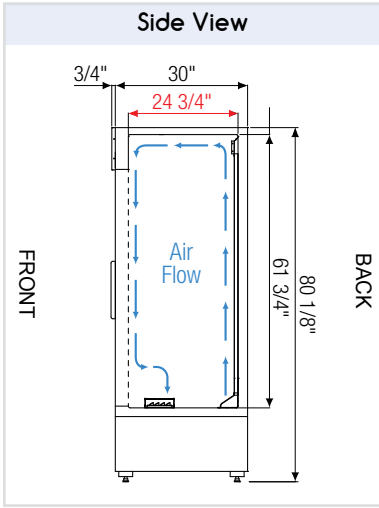

 Equipped with 9 ft long NEMA 5-15P plug.

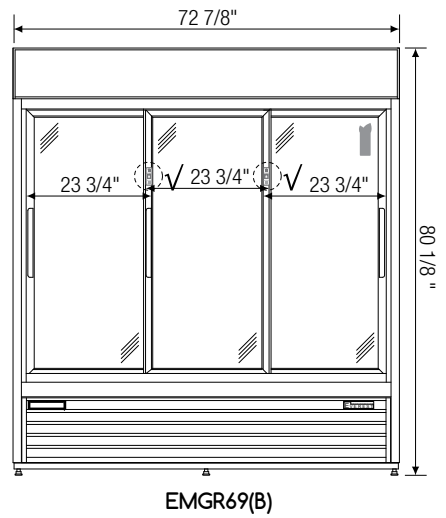
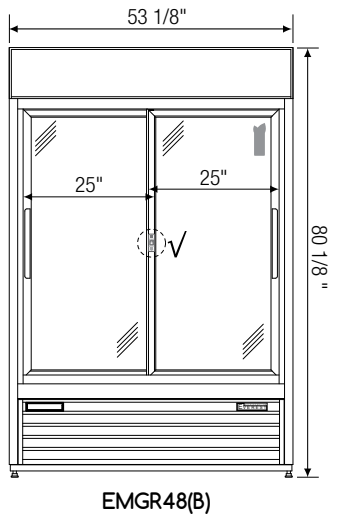
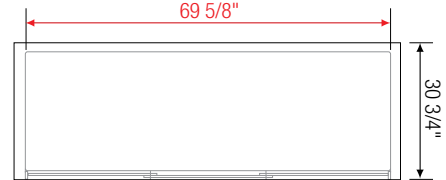
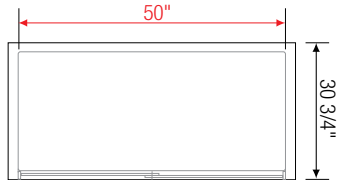

| Model | Ref/ Frz/ Dual | # of Doors | Capacity (Cu. Ft.) | Capacity 20 oz. Bottles | HP | Refrigerant | # of Shelves | Power (V-Hz-Ph) | Amps | Crated Weight (LBS) | Exterior Dimensions (Inches) | | |
|-----------|----------------------|---------------|-----------------------|-------------------------------|-----|-------------|-----------------|--------------------|------|---------------------------|---------------------------------|--------|--------|
| | | | | | | | | | | | L | D | H |
| EMGR33(B) | Ref | 2 (sliding) | 33 | 336 | 1/3 | R290 | 8 | 115-60-1 | 2.5 | 416 | 39 3/8 | 30 3/4 | 80 1/8 |
| EMGR48(B) | Ref | 2 (sliding) | 48 | 448 | 1/2 | R290 | 8 | 115-60-1 | 6 | 533 | 53 1/8 | 30 3/4 | 80 1/8 |
| EMGR69(B) | Ref | 3 (sliding) | 69 | 672 | 3/4 | R290 | 12 | 115-60-1 | 7 | 684 | 72 7/8 | 30 3/4 | 80 1/8 |

Specifications subject to change without notice.

Ref = Refrigerator

Product dimensions are for general purposes and not absolute value. Product capacity (↑) is calculated based on standard industry figures. Slight variations may exist. If dimensions and capacity are critical, please contact Everest Refrigeration.